



7 INCH HD TOUCHSCREEN

BT/AM/FM/USB/TF/MP5 REARVIEW CAMERA

WWW.SANPTENT.NET

support@sanptent.net



Please scan the QR code
Follow the official website for more instructions



USER'S MANUAL

7 INCH HD TOUCHSCREEN

BT/AM/FM/USB/TF/MP5 REARVIEW CAMERA



Contents

Notes.....	1	CarPlay Display.....	11	Media Player Source Switching.....	16
Cautions.....	2-3	Disable Apps.....	11	Media	17
Basic Product Operation	4-6	Android Auto	12	Warnings.....	17
Front Detail	4-5	Warnings.....	12	USB Playback.....	17
Rear Detail	6	Using Android Auto.....	12	Photos.....	17
Using/Caring for the Touchscreen.....	7	Mirror Link	13	Radio	18
Navigating the Menus.....	8-9	Bluetooth®	14	Display Overview.....	18
Apple CarPlay	10	Cautions.....	14	Controls.....	18
Warnings.....	10	Setup & Connections.....	14	Tuning.....	18
Using CarPlay.....	10	Phonebook.....	14	Bands.....	18
Gestures & Control.....	10	Calling.....	15		
		Audio.....	16		
		Track Control.....	16		

Contents

General Settings	19
Cautions.....	19
System Language.....	19
Date & Time.....	19

Audio	20
EQ.....	20
Balance/Fader.....	20
Loudness.....	20
Volume.....	20
Source level.....	20

Connections	21
Cautions & Warnings.....	21
Power	21-22
Speaker.....	23-24
Audio Pre-amp	25
Camera	26-28

Troubleshooting	29-31
Specifications	32

Important

This symbol with “WARNING” is intended to alert the user to the presence of critical instructions/procedures. Failure to observe the instructions/procedures can result in injury, death, damage to the product and/or property.



This symbol with “CAUTION” is intended to alert the user to the presence of important instructions/procedures. Failure to observe the instructions/procedures can result in injury or damage to the product and/or property.



Use of the Apple CarPlay logo means that a vehicle user interface meets Apple performance standards. Apple is not responsible for the operation of this vehicle or its compliance with safety and regulatory standards. Please note that the use of this product with iPhone or iPod may affect wireless performance.

iPhone is trademark of Apple Inc., registered in the U.S. and other countries.

Apple CarPlay is a trademark of Apple Inc.

The *Bluetooth*® word mark and logos are registered trademarks owned by Bluetooth SIG, Inc. and any use of such marks by SANPTENT Digital Media Receiver is under license. Other trademarks and trade names are those of their respective owners.

Caution

Installation Precautions

SANPTENT Digital Media Receiver does not recommend to install the product yourself.

We recommend to have it professionally installed by a certified professional.

Always consult with a professional installer.

Do not attempt to install or service this product by yourself. Installation or servicing of this product by persons without professional training and experience in electronic equipment and motorized vehicle accessories may be dangerous and could expose you to the risk of electric shock, injury or other hazards.

Refer any repairs to a qualified SANPTENT Digital Media Receiver Service Center.

Before Installing

To avoid potential shorts in the electrical system, be sure to disconnect the (–) battery cable before installation.

Use this unit with a 12-volt battery and negative grounding only. Failure to do so may result in a fire or malfunction.

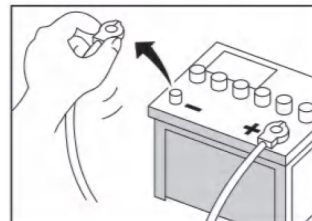
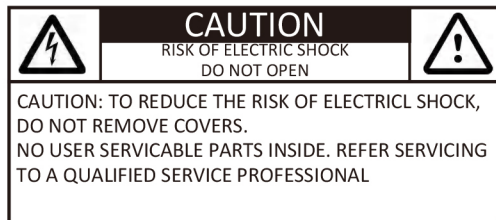

Product Safety

It is against Federal and Local laws for video to be viewed by the driver while the vehicle is in motion. This video product was intended to be used with the parking brake safety feature. Video cannot be seen without the proper parking brake powered connection. Tampering or disabling this feature will void any and all warranty. Please check with a professional installer to have your product installed properly.

Caution

Images and Video

Watching video while driving is against Federal, State, and Local laws.

Drive safely, know and obey traffic rules. Watching this screen and making selections while driving can lead to a serious accident.

Check surroundings for safety while camera images are displayed.

Do not use features of this product while driving if it cannot be operated safely and legally in your location. Before operation of smartphone Apps accessible from this device, read safety instructions in your Owner's Manual. When using navigation Apps stay alert to observe real world conditions.

About this manual

To entirely understanding how to properly use your new SANPTENT product, it is recommended to read this entire user's manual, and keep it in a safe place for future reference.

- Read the entire manual
- Keep the manual
- Follow all instructions
- Clean with a dry cloth only
- Do not use or operate near water
- Do not defeat any safety features



Important Note

Due to ongoing enhancements, example images on screens may slightly differ from actual product.

Basic Product Operation

Front Detail

Model: 7660



1 FM/AM Control

Press it to adjust the channel of FM/AM.

4 SD Card Slot

Insert SD card to read information.

7 USB Port

Insert the USB cable or USB flash drive to read the information.

2 Mute/Power ON/Off

Press it to turn on/off or mute the device.

5 AUX Port

Insert the AUX plug to read audio information.

8 Touch Screen

LCD display Information when operation the unit.

3 Volume Control

Rotate it to adjust the volume level.

6 RES

Using toothpick to press and release the Reset button.

Basic Product Operation

Front Detail

Model: 7023、7068、7113



1 RES

Using toothpick to press and release the Reset button.

4 Volume -

Press once on either "-"
Long press to quickly decrease the volume.

2 Volume +

Press once on either "+"
Long press to quickly increase the volume.

5 AUX Port

Insert the AUX plug to read audio information.

3 Mute/Power Off

Press it to turn on/off or mute the device.

6 USB Port

Insert the USB cable or USB flash drive to read the information.

7 Touch Screen

LCD display Information when operation the unit.

Basic Product Operation

Front Detail

Model: 7115



1 SD Card Slot

Insert SD card to read information.

2 USB Port

Insert the USB cable or USB flash drive to read the information.

3 AUX Port

Insert the AUX plug to read audio information.

5 Volume Control

Rotate it to adjust the volume level.

6 Mute/Power ON/Off

Press it to turn on/off or mute the device.

7 FM/AM Control

Press it to adjust the channel of FM/AM.

8 NAVI

9 RES

Using toothpick to press and release the Reset button.

10 Touch Screen

LCD display Information when operation the unit.

Basic Product Operation

Rear Detail

Model: 7660、7023、7068、7115

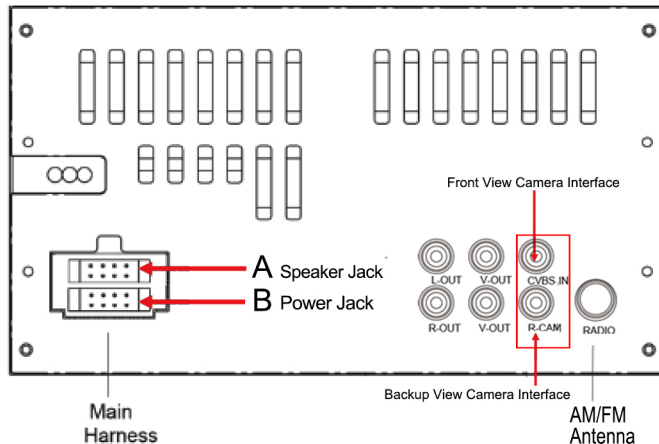

Model: 7113

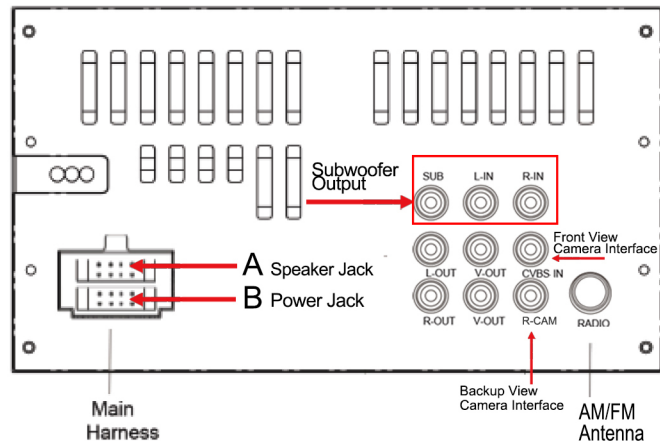

Basic Product Operation

Using and Caring for the Touchscreen



Use:

This head unit utilizes a capacitive touchscreen, the same type that is used on high-end mobile devices. As with all capacitive type technology, if your fingers are wet or sweaty, it will not function properly. Do not allow any sharp objects to come in contact with the screen glass.

Care and Cleaning:

To clean the screen, you can use a dry microfiber type cloth. Do not use ammonia, window cleaner, or any other type of household chemicals to clean the screen. Abrasives should not be used at all.

Specifications

Navigating the Menus

FM



Carplay



Mirror Link

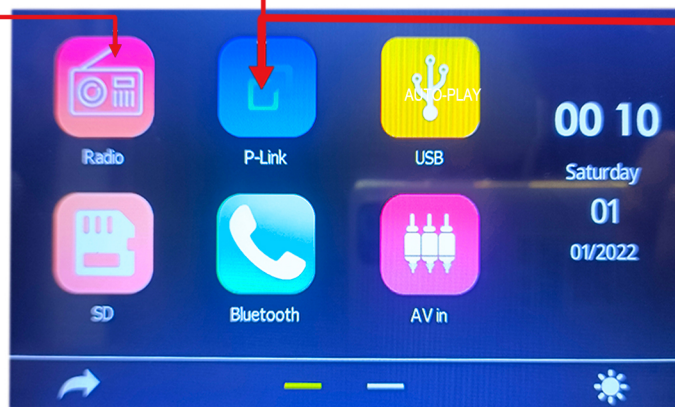
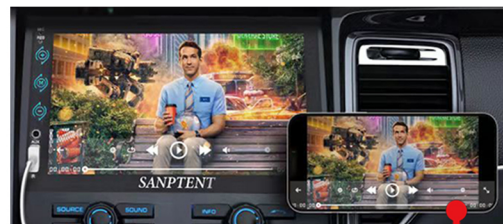

Specifications

Navigating the Menus

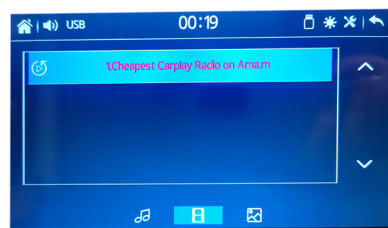

Media

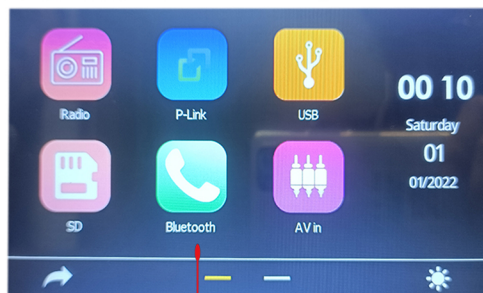

Bluetooth

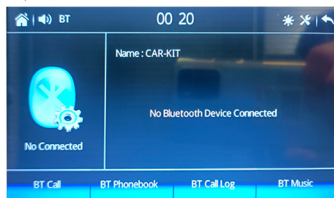

General

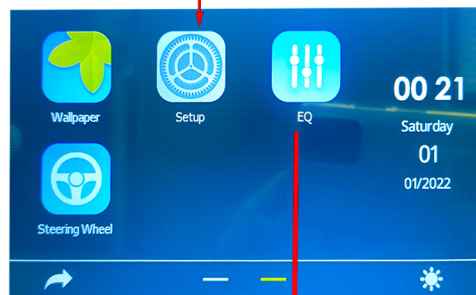

EQ



Using CarPlay



Note

Apple CarPlay usage is limited while driving.

Functions, contents, and usability is determined by the App provider(s).

Controls will vary with each App that is available for CarPlay.

For more details visit:

<http://www.apple.com/ios/carplay>



WARNING

Familiarize yourself with your Local and State laws regarding mobile devices.

Certain functions of an iPhone might be prohibited and or illegal while driving in your location.

When in doubt, park the vehicle and engage the parking brake first before performing the function(s).

Connecting to CarPlay USB Port

1. On the display settings page, choose "Phone Link" - "Carplay" to allow your phone enter the CarPlay menu.
2. Connect the CarPlay compatible device via USB cable (not included).
3. When your iPhone pops up a dialog box "Trust this device," select "trust".
4. The iPhone will load the CarPlay function.
5. If you want to return to the product **Home** menu, Touch "CarHome"



NOTE

The product's Bluetooth will turn **OFF** automatically when CarPlay is in use. Hands-free phoning will function through the CarPlay feature.

When using CarPlay, there is no need to pair your iPhone, the USB cable connected through the USB Port will enable this feature.

If other devices are connected via Bluetooth, they will be disconnected for the duration of CarPlay use.

Gestures & Control

Basic controls, but not limited to:

Touch



Swipe



Dragging



Other gestures and controls might differ on each App.



NOTE

Volume control is handled exclusively by the product.

Apple CarPlay

Using CarPlay

CarPlay Display Setup

1. Using your iPhone:

Settings > General > CarPlay

2. **Touch and Hold** each App icon to move.

To remove an App, Touch 

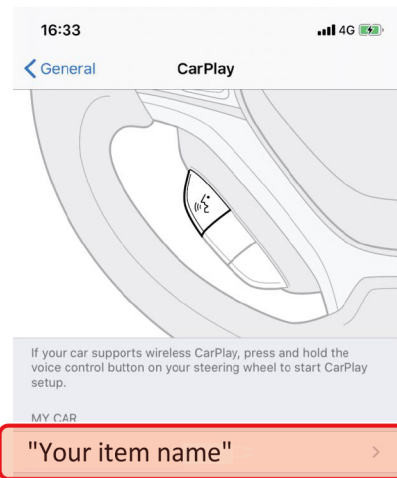

NOTE

Only Apps with the  icon can be removed from CarPlay.

Only Apps with the  icon can be added in carplay.

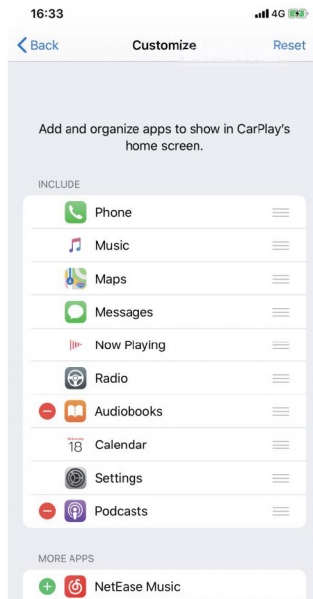

How to Disable Apps

1. Using your iPhone:

Settings > Notifications > App to Disable

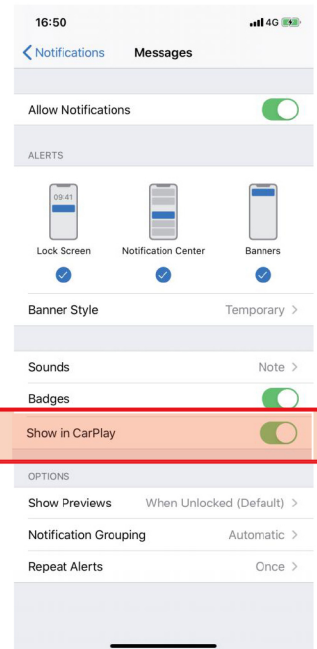

Using Android Auto



Note

Android Auto usage is limited while driving.

Functions, contents, and usability is determined by the App provider(s).

Controls will vary with each App that is available for Android Auto.

For more details visit:

<https://www.android.com/auto/>



WARNING

Familiarize yourself with your Local and State laws regarding mobile devices.

Certain functions of the mobile device might be prohibited or illegal while driving in your location.

When in doubt, park the vehicle and engage the parking brake first before performing the function(s).



NOTE

To complete the setup properly, the Parking Brake status wire must be connected.



WARNING

For your safety, the setup process **MUST** be accomplished while the vehicle is **Parked and Parking Brake Engaged**.

Android Auto App

1. For Android 9.0 or earlier, download and install the Android Auto app from Google Play. For smartphone with Android 10.0 or later, plug in your phone and follow the prompts on your phone to accept the permissions that Android Auto requires



Minimum Requirements:

Android 5.0 Lollipop

For a list of compatible devices:

<https://www.android.com/auto/>

Updating Related Apps

1. During the first start up and setup of the Android Auto app, the Maps, Music, Google apps will install/update automatically.

Connecting to Android Auto USB Port

1. Connect the Android compatible device via the appropriate USB cable (not included).
2. The Android device will load the Android Auto function.
3. Bluetooth will connect automatically when the setup is completed.

Android Auto Permissions Permissions

Several features can be allowed or denied access to customize your usability of the product.

The access can always be modified in Settings on the Android device.

Using Mirror Link



Note

Mirror Link usage is limited while driving.

Functions, contents, and usability is determined by the App provider(s).

Controls will vary with each App that is available for Mirror Link.



WARNING

Familiarize yourself with your Local and State laws regarding mobile devices.

Certain functions of the mobile device might be prohibited and or illegal while driving in your location.

When in doubt, park the vehicle and engage the parking brake first before performing the function(s).



WARNING

For your safety, the setup process **MUST** be accomplished while the vehicle is **Parked and Parking Brake Engaged**.

Mirror Link for iPhone

1. Set up - Phone Link - iOS Mirror
2. Use the original data cable to connect the car stereo and mobile phone with.
3. When the phone pops up a dialog box: "Trust This Computer? ", Select "Trust" to enter the interconnect mode.

Mirror Link for Android

1. Set up - Phone Link - AOA
2. Use the original data cable to connect the car stereo and mobile phone with.
3. When the phone pops up a dialog box: "Trust This Computer? ", Select "Trust" to enter the interconnect mode.



NOTE

The Mirror Link function supports for most cell phones (support Android 10.1 and below, iOS 15.3.1 and below, pixels: 1920*1080 and below currently. We are still in the process of updating)



NOTE

To complete the setup properly, the Parking Brake status wire must be connected.

Setup & Connection

Hands-Free Menu

Touch Bluetooth



NOTE

CarPlay must not be active. If being used, disconnect the iPhone to start Bluetooth.

Compatibility with all mobile devices is not guaranteed. Please read through the user's guide of the mobile device.



CAUTION

For your safety, the setup process should be accomplished while the vehicle is parked and parking brake engaged.

First time Pairing

Using your phone, media or other Bluetooth device, try to connect to this headunit.

Mobile Device:

Search for **Sanptent**

iOS Devices: **Settings > Bluetooth**

Android Devices: **Settings > Connections > Bluetooth**

A passcode is generated and will display on both the head unit and mobile device for secure pairing.

Touch  to confirm

Every time the product is powered ON, the mobile device will automatically connect if within range.



NOTE

Once paired and connected, the device list will display the available Bluetooth profiles.

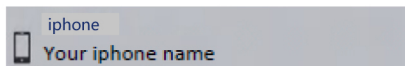

Phonebook

To Download Phonebook:

Touch



and it will start

download Phonebook

Hands-Free

Calling

Making & Receiving Calls

1. Dialing from the dial pad

Touch  to make call

2. Contacts

Touch the contact name

3. History

Choose the name, then

To **End** a call **Touch**



To **Mute** a call **Touch**



Dial pad

To use the dial pad while on a call

Touch BT Call

Searching History

Swipe Up or **Down** to search



Connection: **ON**

Auto Connect: **ON**

Auto Answer: **OFF**

Device Name: **Sanptent**

Audio

Audio Streaming

To play media through Bluetooth, the mobile device must be **Paired and Connected** to the SANPTENT

1. Touch **BT Music**

The music will play automatically.

Track Control

1. Play/Pause



2. Track Fwd / Rev



3. **Swipe** to Fwd/Rev



Note

For best performance, your mobile device volume setting should be set to maximum.

All volume adjustments for the system should be controlled from the product.

The unit will recall the last volume setting on your mobile device every time is connected.

Formats

Playback is supported from the mobile device with any format it can play.

Audio will only be played by the product.

Video cannot be viewed on the unit.



Note

USB source will only be displayed if a USB drive is inserted and has playable media.

Display

Track info will be displayed when available.

Track, Album and Artist.

Album art is not supported via Bluetooth playback.

USB/SD

USB/SD Playback

Touch **USB/SD**

The music will play automatically.

Audio Control

1. Play/Pause 
2. Track Fwd / Rev 
3. Random 

Video Control



1. Play/Pause 
2. Track Forward/Backward 
3. SETUP 

Photo Control

1. Play/Pause 
2. Track Forward/Backward 



Watching videos or photos while driving is against Federal, State, and Local laws.

Do not use features of this product if it cannot be operated safely and legally in your location.



Review the connections of this product, to properly integrate the parking brake wire to the vehicle.

Video and or photos cannot be viewed while driving. The vehicle must be stationary and the parking brake applied to enable viewing.



Only these two models (7660 and 7023) have SD card function.

If there are other files in the USB, music files will play First.

Radio

AM/ FM

Controls

Touch **RADIO**



Tuning

To search for stations:

Search

Touch and Hold  

Manual Seek

Touch  

Auto Search & Store: Touch 



Auto Search
& Store

Bands

LOC/DX

Band & Settings

Touch  to switch bands

LOC/DX

To select Local or Distant broadcasting stations,

Touch 

General

System Language

Touch **Set up** ➔ **Language** to change the

English (Default)



Note

CarPlay is independent of the system language setting.

Date & Time

Touch **Set up** ➔ **Time Set up** to change the

default date and time

24H Mode *OFF*

ON

Touch



Background Settings

Touch **Wallpaper** to change

the default date and time

Factory Settings

To restore settings to default:

Touch the Restore Default



CAUTION

Will restore all settings to factory defaults.

All settings and presets will be lost.

Brake

Touch **Set up** ➔ **Brake**

to change the front camera screen to jump automatically.

Note:

For your safety, Do not watch while driving.

Keeping the screen resting.

Note:

Touch **Set up** ➔ **system** ➔ Stay on the home page.

Audio

EQ

To access the EQ menu

Touch **EQ**



Preset EQ

Jazz, HipHop, Pop, Rock, Custom, DBB, Classic

Balance/Fader

Left/Right Balance, Touch



Swipe for quick adjustment



Front/Rear Fader, Touch



Swipe for quick adjustment



Volume

Settings are for default volumes for Main(Radio, Media), Hands-free(BT Ring, BT Talking), Apple CarPlay/Android Auto (Navi, Voice).

Source Level

The source mode(Radio, USB, SD, BT Audio, AV Input, Apple carplay, Android Auto) gain control.

Loudness

Enhances and gently boosts low and high freq.

Touch 

Note

The 7113 has Built-in Subwoofer Output which gives you better listening experience.

Connections

Power

Model: 7660、7023、7068、7115

⚠ CAUTION

It is recommended to have the product installed by a certified installation professional.

⚠ CAUTION

Before installation, or wiring connections, disconnect the negative (-) battery terminal to prevent damage to the product, and/or possible injury.

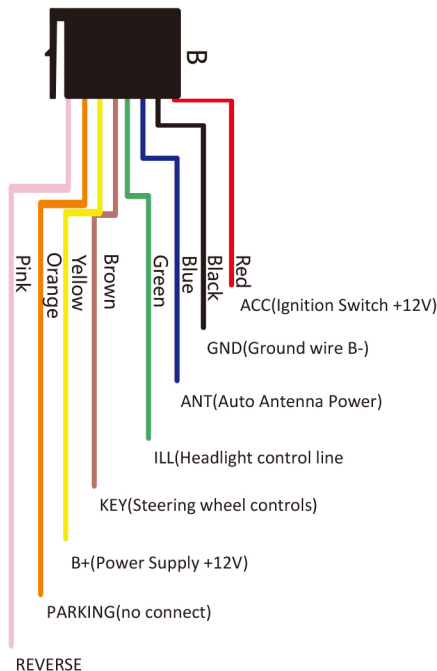
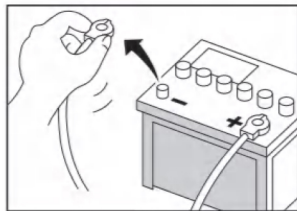

i Note

Unused input/output wires need be insulated with tape, heat shrink, or crimp connectors. **Never use wire nuts.**

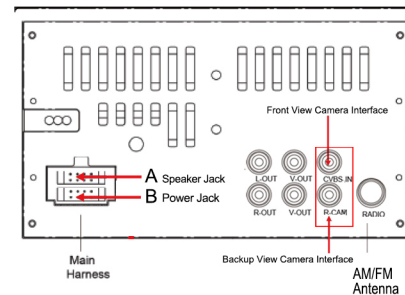

i Note

A separate interface might be needed for your vehicle application. It is recommended that you consult with a professional installer.

i Note

When replacing the fuse, always do so with the same type and value (10 A).

Connections

Power

Model: 7113

⚠ CAUTION

It is recommended to have the product installed by a certified installation professional.

⚠ CAUTION

Before installation, or wiring connections, disconnect the negative (-) battery terminal to prevent damage to the product, and/or possible injury.

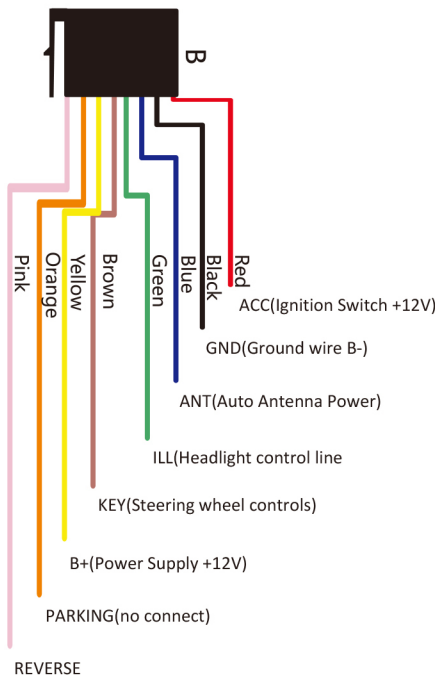
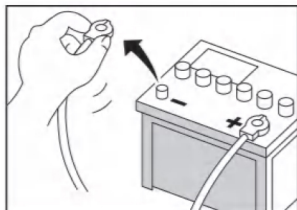

i Note

Unused input/output wires need be insulated with tape, heat shrink, or crimp connectors. **Never use wire nuts.**

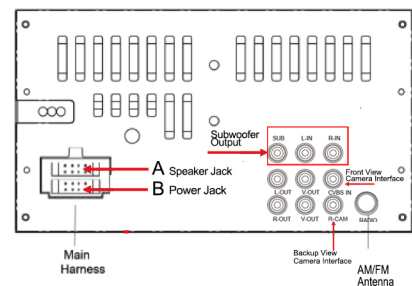

i Note

A separate interface might be needed for your vehicle application. It is recommended that you consult with a professional installer.

i Note

When replacing the fuse, always do so with the same type and value (10 A).

Connections

Speakers : 7660\7023\7068 \7115 model

⚠ CAUTION

Do not chassis ground any speaker wire leads.

⚠ CAUTION

Only use 4-8 Ω Speakers

Do not use 1-3 Ω Speakers

⚠ CAUTION

Do not bridge any of the channels, they are only to be wired in stereo mode.

i Note

Unused speaker wires need to be insulated with tape, heat shrink, or crimp connectors.

Never use wire nuts.

If the speaker outputs are not used, turn **Off** the internal amp to reduce the possibility of noise entering the signal chain.

i Note

Observe speaker polarity when making connections.

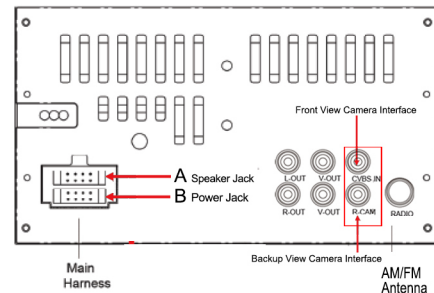
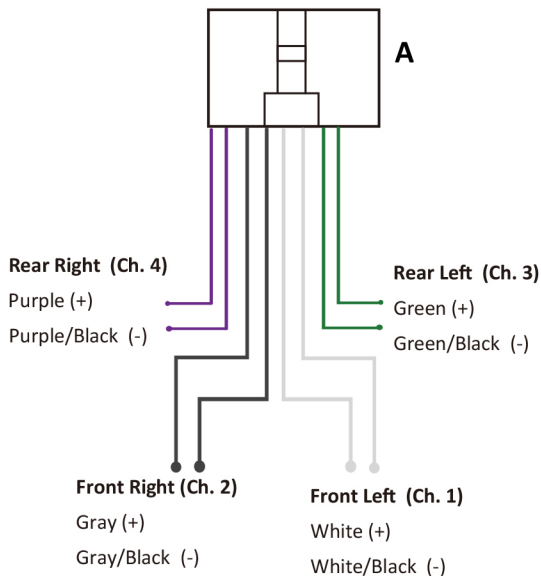

Connections

Speakers : 7113 model

⚠ CAUTION

Do not chassis ground any speaker wire leads.

⚠ CAUTION

Only use 4-8 Ω Speakers

Do not use 1-3 Ω Speakers

⚠ CAUTION

Do not bridge any of the channels, they can only be wired in stereo mode.

i Note

Unused speaker wires need be insulated with tape, heat shrink, or crimp connectors.

Never use wire nuts.

If the speaker outputs are not used, turn **Off** the internal amp to reduce the possibility of noise entering the signal chain.

i Note

Observe speaker polarity when making connections.

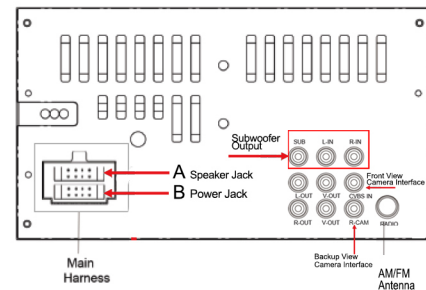
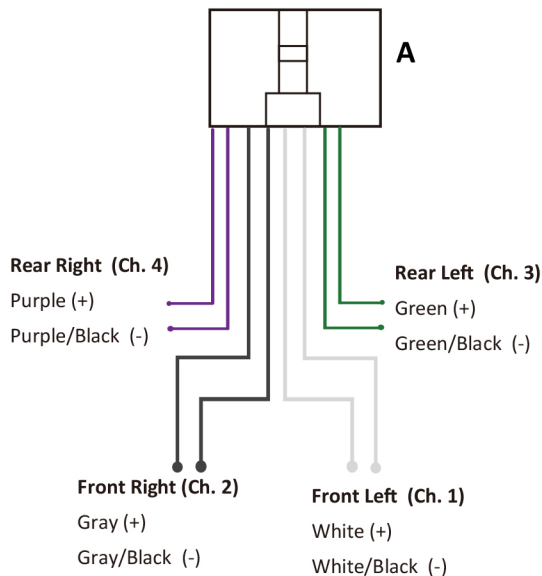

Connections

Audio Pre-amp

Note

Subwoofer Pre-amp is a non-fading mono output.

Note

Always run signal wires away from power cables to reduce the possibility of noise.

Note

Only the 7113 model supports for Subwoofer Pre-amp.

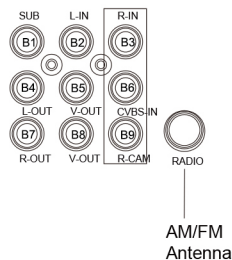

- B1: Sub-woofer output
- B2: Auxilliary left speaker input
- B3: Auxilliary right speaker input
- B4: Left audio output
- B5: Video output 1
- B6: CVBS input
- B7: Right audio output
- B8: Video output 2
- B9: Reversing video input

Note

If pre-amp outputs are being used exclusively, turn **Off** the internal amp of the product, to reduce the possibility of noise entering the signal chain.

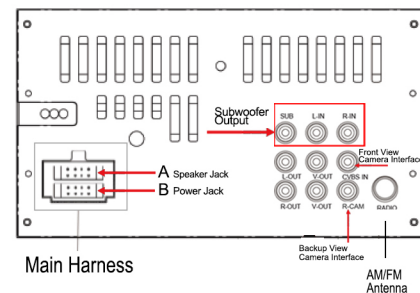

Connections

Camera

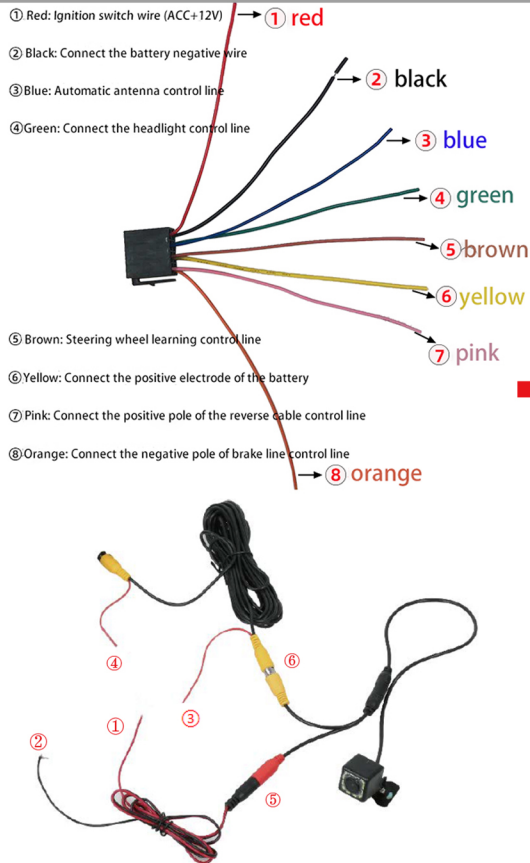

The wiring steps of front and rear view cameras:

1. The **red** wire should connect with the ignition switch wire (ACC+12V), the **yellow** wire should connect the positive power supply (B+12V). And the black wire should connect the negative pole.

2. As shown in the pictures on the left, the wire ① is connected to the positive pole, and the wire ② is connected to the negative pole. And then connect the cable to the camera's red hole together like ⑤.

3. Then you can connect the extension cord's plug to the camera's yellow hole plug (**yellow**) like ⑥.

4. The other end of the extension cord (**yellow**) plug in the hole in the back of the car stereo. (The location of the camera input were shown in the image on the next page.)

5. The installation of the reversing view camera input requires an additional wiring step before plug in the hole in order to view videos: connect wire ④ with the **pink** wire together.

And then you can choose two ways to activate video:

1). You can connect wire ③ to tail light line on the car.

Or

2). You can connect the reversing line (**pink** wire), the wire ④ and reversing switch line together.

Note: Select AV/IN on the home page to activate front camera video; the rear camera video will be automatically activated when you reversing.

When wiring, be sure to keep the car engine off.

Connections

Camera

Model: 7660、7023、7068、7115

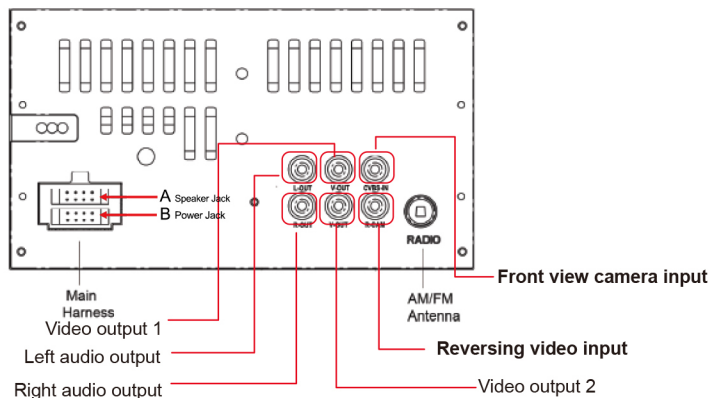

Model: 7113

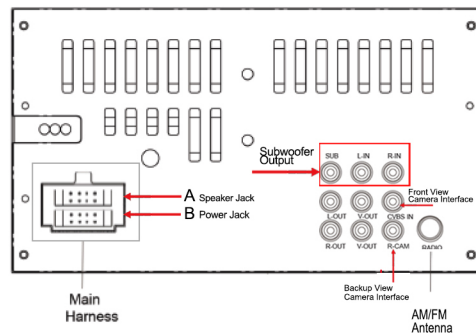

WARNING

Never rely solely on the rear view camera; always check your surroundings before proceeding.

Images may appear reversed

Do not use a feature of this product if it cannot be operated safely and legally in your location.

Note

The 7660 model has only one camera and the 7023、7068、7113 models have two cameras, please wiring according to the actual situation of the product you buy.

And the 7113 model's explanation of connection holes on the page 25.

Connections

Camera

REAR INTERFACE DESCRIPTION

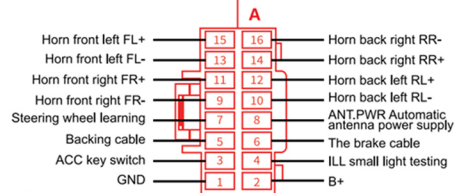
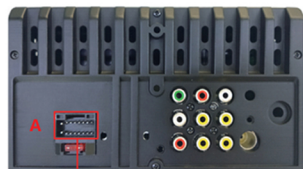

WARNING

Never rely solely on the rear check your surroundings before proceeding.

Images may appear reversed

Do not use a feature of this product if it cannot be operated safely and legally in your location.

REAR INTERFACE DESCRIPTION

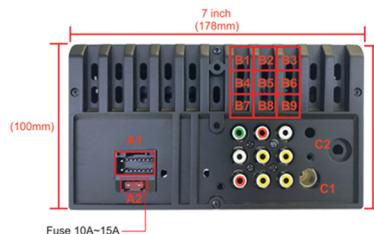

A1	Audio cable
A2	Fuse
B1	Sub-woofer output
B2	Auxiliary left speaker input
B3	Auxiliary right speaker input
B4	Left audio output
B5	Video output 1
B6	CVBS input
B7	Right audio output
B8	Video output 2
B9	Reversing video input
C1	Radio antenna
C2	Extraposition MIC(optional)

Note: This connection is designed for another style of 7113 model.



Note

The 7660 model has only one camera and the 7023, 7068, 7113, 7115 models have two cameras, please wiring according to the actual situation of the product you buy.

And the 7113 model's explanation of connection holes on the page

Troubleshooting

Issues	Cause	Solution
No Sound	Internal amplifier is off Product is muted External amplifiers Audio source	Go to Settings > Audio > Internal Amp ON Touch the volume. Check the external amplifiers are on. Check the remote output wire has voltage Change the audio source
Media Not Supported	Media on USB flash drive	Change the media format on the USB device Change the USB device
Bad Radio Reception	Radio area Antenna	Change the station Turn OFF AF and TA Turn OFF RDS/RBDS Antenna output wire isn't connected Connect Antenna to product
Apple CarPlay/Android Auto will not start	Bad Lightning®/USB cable Locked device Not charged CarPlay/Android Auto frozen	Replace the cable Device needs to be unlocked Device needs to be powered ON for CarPlay/ Android Auto to function. Allow it to charge and power on. Unplug the device, close all Apps and plug it in again.
Bluetooth	Not connecting to device Phone sound quality is poor	Make sure the device is within range. Devices' Bluetooth connection needs to be turned ON Reduce the distance between the unit and the mobile phone Move the car to a place where you can get a better signal reception

Troubleshooting

Issues	Cause	Solution
Camera	The image is reversed	Go to Settings > Audio > Internal Amp ON . Touch the volume.
	Audio source	Check the external amplifiers are on. Check the remote output wire has voltage. Change the audio source.
Hands-free call quality	Mobile device	Check cellular strength on mobile device. End call and redial number.
	Microphone	Microphone placement needs to be relocated. Microphone needs to be firmly attached to location it's mounted on. Check to see if microphone is properly plugged in.
Unit is unresponsive	Processor has frozen	Press the RESET button on the front panel.
Nothing happens when buttons are pressed Display is not accurate	Unit need to be reset	Using a pen or toothpick, press and release the Reset button.
	Panel or ment unit connectors are dirty	Wipe the dirt off with a soft cloth moistened with cleaning alcohol.

Troubleshooting

Issues	Cause	Solution
No power	The fuse is blown	Replace the fuse
The operation keys do not work	The built-in microcomputer is not operating properly due to noise.	Press the power button for about 10 seconds to reset the unit.
	Front panel is not properly fix into its place.	Press the power button for about 10 seconds to reset the unit.
Sound skips	The installation angle is more than 30 degrees.	Adjust the installation angle to less than 30 degrees.
	The USB or SD card is extremely dirty or defective.	Clean the USB or SD card / try to play a new one.
The camera output video is reversed	Wrong camera installation position	The iron of the camera needs to be connected to the car towards the top.
System Updates		Please contact us on the official website and we will send you the upgrade software.



If you have questions about this product:

Customer Service

Tech Support: <http://www.sanptent.net/>

support@sanptent.net

General

Power Input.....	8.5 V—16V DC
Nominal.....	14.4 V DC
Current Consumption.....	10A
Fuse Type.....	10A
Dimensions (H x W x D).....	4.3" *5.8" *8.1
Head Unit Weight.....	1.9 lbs.
Operational Temperature.....	-4—158°F

Display

Screen Size.....	7"
Aspect Ratio.....	16 x 9
Resolution.....	1024 x 600
Screen Type.....	LED Active Matrix

Audio

Max Power.....	20W x 4 Ch.
Acceptable Speaker Load.....	4-8 Ω
Preset EQ.....	6
Custom, JAZZ, HIPHOP, POP, ROCK, R&B	
EQ Bands, Adjustable.....	10
32, 63, 125, 250Hz, 500Hz	
1KHz, 2KHz, 4KHz, 8KHz, 16KHz	
EQ Boost/Cut.....	± 6 dB

Radio Tuner

Freq. Range.....	87.5 MHz-108 MHz (FM)
Freq. Range.....	522 kHz-1710 kHz (AM)
USA 1 Range (FM).....	100 kHz Spacing
USA 2 Range (FM).....	200 kHz Spacing
Europe Range (FM).....	50 kHz Spacing

Apple CarPlay

iPhone Support.....	iPhone 5 or Newer
iOS.....	iOS 7.1 or Newer

Android Auto

Supported.....	(5.0) Lollipop or Newer
----------------	-------------------------

USB/SD

USB Spec.....	USB 2.0 (High-Speed)
USB Port 1: Carplay & Android Auto.....	
Current Output 1.5A	
USB Port 2: Media & 1.5A Charging	
Current Output 1.5A	
File System.....	FAT32
Audio Playback.....	WAV, MP3
Video Playback.....	AVI, MKV, WMV
Picture Playback.....	JPG, PNG, BMP

*Not all listed compressed files guaranteed to play due to different creation methods or file contents.

Bluetooth®

Version.....	v4.2+E.D.R.
Audio Codec.....	S.B.C.